

3-D ALIEN MINER ROBOT

ASSEMBLY INSTRUCTIONS

Time to Complete: Approximately 30 minutes Level: Easy



GETTING STARTED

Materials:

- Metal-edged ruler
- Butter knife
- Scissors or X-ACTO knife
- Cutting mat (optional)
- Multipurpose glue

- 1** Score all the pieces: Using a ruler as a guide, run the back side of a butter knife firmly along all the dotted lines.



- 2** Using scissors or an X-ACTO knife and cutting mat, cut out all pieces along the solid lines. Be sure to cut the slit lines where the arms will be inserted on the body.



ASSEMBLE YOUR ALIEN MINER ROBOT

- 3** For the top of the body piece, pull edge of cut line on one tab A over to cover triangle and glue. Repeat with remaining A tabs, holding each until dry.

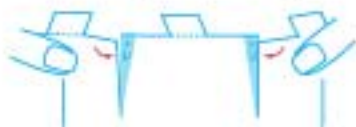

- 4** For the bottom of the body piece, repeat with remaining B tabs, holding each until dry.

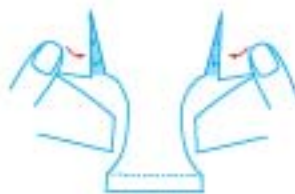

Your body should look like this after all A tabs and B tabs are glued.

- 5** Fold down the bottom of the foot pad and fold the bottom tab up. Turn over and wrap the side panels inward so they align with the bottom footpad. Glue the left side panel to the bottom tab and then glue the right side panel over the left side panel. Make sure that the legs wrap around the edges of bottom footpad evenly. Repeat on opposite leg.



Front view of body



Back view of body

- 6** Glue tab C to close the body assembly, with the seam running up and down the back of the body. When through, the body shell should slope and taper slightly, forming a cylindrical shape.



Fold and glue front bottom flap to the inside of the back to enclose the bottom of the body.



ASSEMBLE YOUR ALIEN MINER ROBOT (continued)

- 7** For the arms, fold down in a mountain fold on the two middle score lines forming the blue oval. Fold up in a valley fold on the outside score lines. Glue the machine-like arms together—leaving the tabs unglued.



- 8** Stick arms into slits in body. Fold over on dotted lines and glue in place inside body.



- 9** For the head, gently bend the panels of the head assembly so that the whole thing forms a dome-like shape. Glue the A tabs of each panel to the inside of the next panel so that the head resembles an igloo.



- 10** Fold the long flaps inward and glue one flap to the inside of the opposite side of the circle. Punch a hole the center of the flap and insert a brad, head side down. Repeat step to the other flap and inserting the brad in the hole before gluing down.



- 11** Puncture the brad through the X of the cross piece and into the X of the blue top of the circular neck piece.



- 12** Add glue to the tabs of the body and attach head.

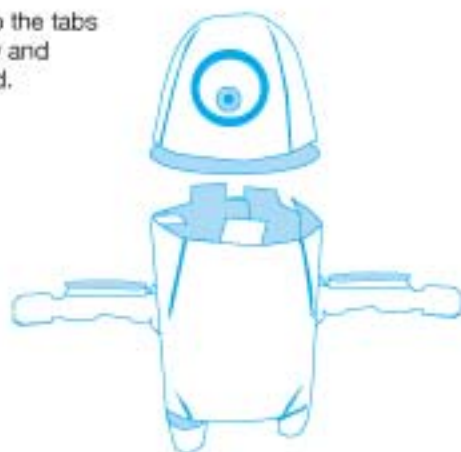

- 13** You're done!

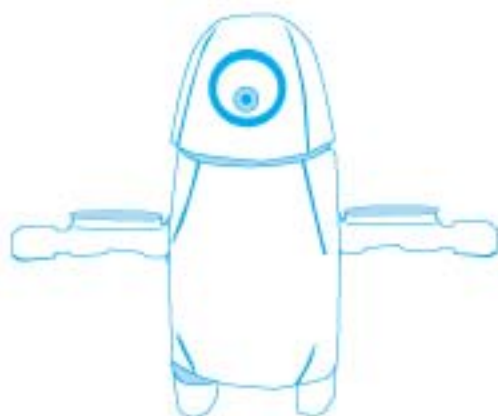

MONSTERS VS ALIENS: 3-D ALIEN MINER ROBOT



